

Satellite Valve Information

355 Pioneer Way
Suite B
Mountain View, CA 94041
800-882-3886
www.ASEPCO.com

ASEPCO focuses exclusively on aseptic processing needs. Our equipment is developed in close cooperation with leading experts in the bioprocessing industry.

A multi-year winner of the Pharmaceutical Processing Innovations Award, ASEPCO's Radial-Diaphragm™ Valves are specifically designed for applications where leakage, "dead legs", or cross-contamination are unacceptable. Our valves provide added security in all high-purity processes. All valves are machined in America from 316L SS bar stock (unless other material is requested), and assemble with a mere sanitary clamp, forming a seal that is the envy of weir style valves, for it requires no tools, never leaks and reduces maintenance cost by 85%. Since we machine each valve from bar stock we have the flexibility to customize our valves to customer specification.

Satellite Valves

The ASEPCO Satellite Valve is a result of our dedication to our customers needs. It was developed to eliminate the dead leg associated with steam ports on closed valves. The ASEPCO Satellite valve seats on the wall of a larger 'host' flush mounted tank outlet valve. Wherever steam or small volumes of flushing liquids must enter a process system, the satellite valve creates a flush entry without a dead leg.

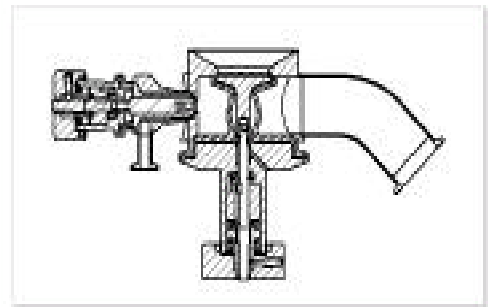

Like its predecessor, this valve is flush mounted to the tank, has no dead legs or dead spaces, is clean and self-draining by design, assembles with a clamp, diaphragm change outs in under a minute, and has integral travel stops. Additionally, the satellite valve gives you the ability to quickly flush or CIP/SIP while the valve is closed allowing for down stream sterility prior to product introduction as well as speeds product changeover. The ASEPCO Satellite valve is .5" in size and can be machined into the wall of any 'host' valve of 1" or greater.

Available Materials

ASME SA 479 316L Stainless Steel
AL6-XN
Hastelloy and Alloy C-22 and C276
Polypropylene

Method of Manufacture

All valve bodies are machined from solid, hot-rolled, bar stock.

Maximum Pressure

250 psi

Maximum Temperature

135° C / 275° F

Outlet End Connections

Sanitary flange or butt weld

Optional Port Connections

Per customer specification

Finishes

20-25 Microinch RA (180 grit)
15-19 Microinch RA (240 grit)
9-11 Microinch RA (320 grit)

Diaphragm Materials

USP class VI medical grade Silicone
Non-cytotoxic EPDM
Viton

Actuators

Autoclavable manual actuator
Compact normally closed or normally open pneumatic actuator
Both actuators feature position and leak indicators and are self contained.

Sizes Available

.5 inch, .75 inch, 1 inch, 1.5 inch, 2 inch, 2.5 inch, 3 inch

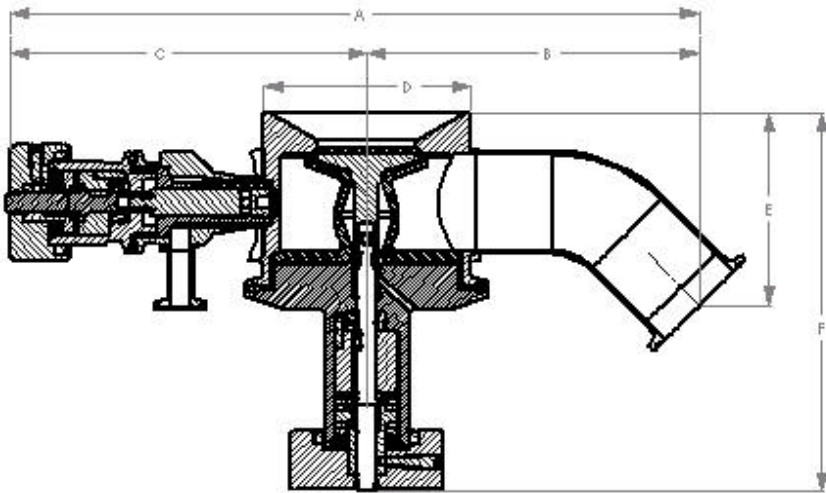

| Dimensions | | | | |
|------------|------|-------|-------|-------|
| | 1.0" | 1.5" | 2.0" | 3.0" |
| A | 9.98 | 12.25 | 13.33 | 16.92 |
| B | 3.78 | 5.35 | 6.43 | 9.24 |
| C | 6.20 | 6.90 | 6.90 | 7.68 |
| D | 2.98 | 4.00 | 4.00 | 4.91 |
| E | 2.45 | 3.51 | 3.75 | 5.22 |
| F | 5.25 | 7.30 | 7.30 | 8.34 |