

MANUAL ACTUATORS

355 Pioneer Way
Suite B
Mountain View, CA 94041
800-882-3886
www.ASEPCO.com

When ASEPCO designed its actuators, we took great care in making them industry appropriate, operator friendly and yet sturdy enough to withstand some pretty rough treatment. We made sure that our pneumatic actuators are not spring loaded, they all are machined from 304 Stainless Steel and are designed to withstand some dings and drops. All actuators have a position indicating shaft that extends when the valve is open (for visual confirmation of valve position) and contain as few o-rings and seals as possible which require very simple maintenance on an annual basis. Additionally, to prevent any galling we machine all our actuator bodies out of 304 Stainless Steel, our diaphragm shafts out of 316 Stainless Steel and our actuator shafts out of Galltough.

All ASEPCO actuators meet 3A requirements and can withstand operating pressure of 250 psi and operating temperature of 135° C (or 275° F).

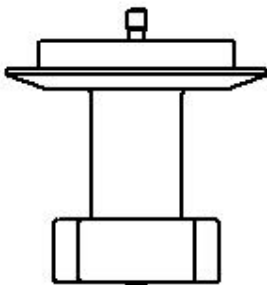

ASEPCO's Manual actuators are powerful and precise machines. They are designed to hold a partially open position indefinitely. Further, they are closed when actuator is merely hand tight (additional torquing of manual actuators may cause damage to the diaphragm).

HEIGHT OF ACTUATORS – From top (knob) to clamp face.

0.5"	Manual Actuator	2.435"
	Maximum travel of position indicator	0.220"
1.0"	Manual Actuator	2.875"
	Maximum travel of position indicator	0.305"
1.5"	Manual Actuator	3.901"
	Maximum travel of position indicator	0.562"
2.0"	Manual Actuator	3.901"
	Maximum travel of position indicator	0.562"
3.0"	Manual Actuator	3.901"
	Maximum travel of position indicator	0.860"

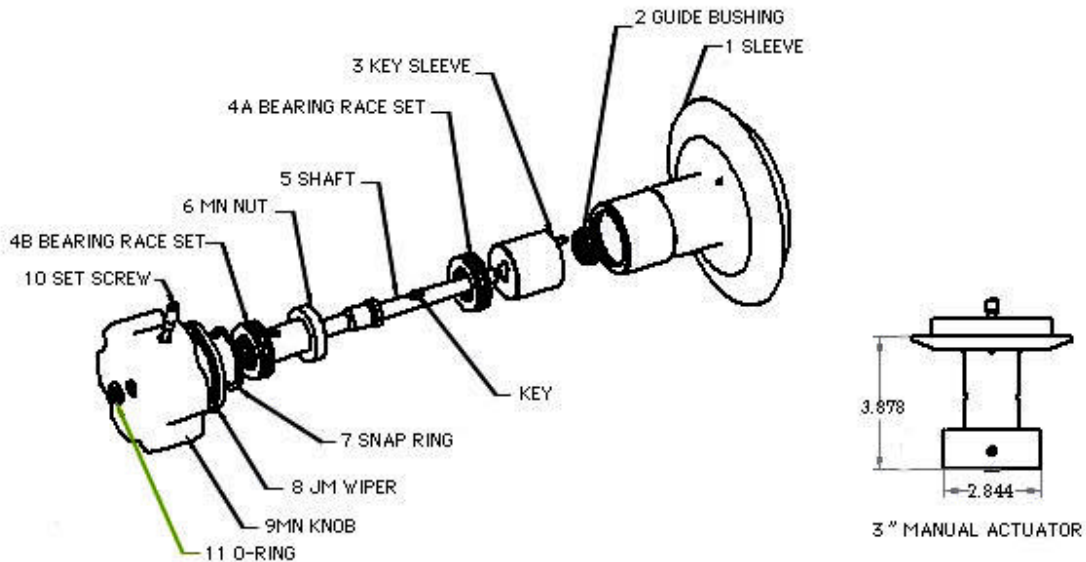

CLEARANCES FOR DIAPHRAGM REMOVAL

0.5"	3.41"
1.0"	4.10"
2.0"	5.60"

MANUAL ACTUATORS SPARE PARTS LIST

PART # MAK-100

** Includes O-rings, guide bushing and wiper seal.

(Please Specify which size Actuator or Valve you have~ O-Rings should be replaced Annually)